

Skisseboken

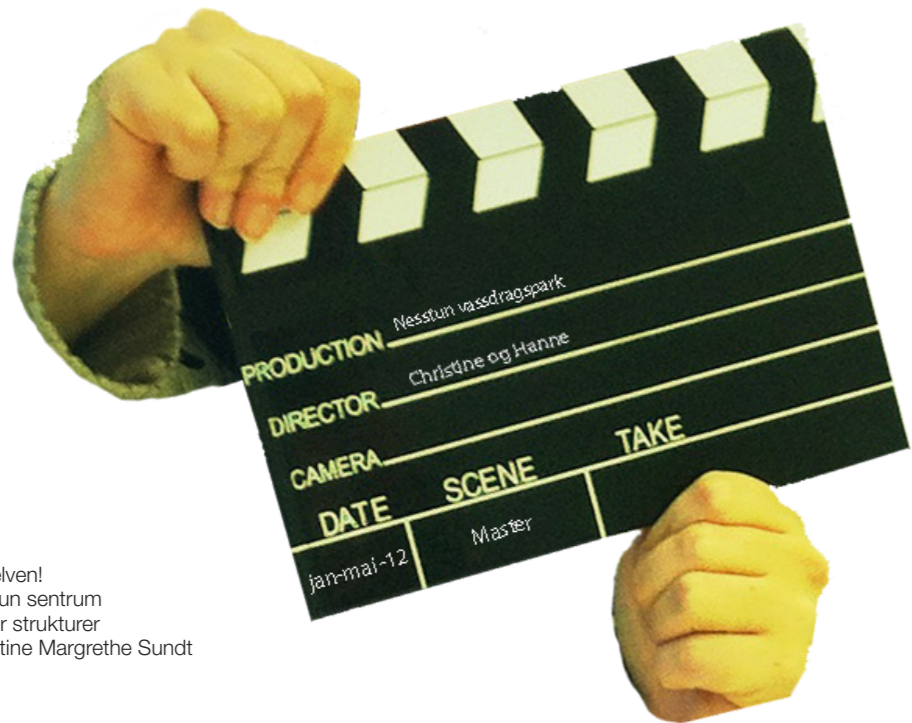

Vedlegg 2: Skisseboken
Neste stopp er Nesttunnelven!
Transformasjon av Nesttun sentrum
med fokus på blågrønner strukturer
Masteroppgave av Christine Margrethe Sundt
og Hanne Lien Bjelke

Denne boken er laget for å vise en del av skisseprosessen og tankene bak resultatet av masteroppgaven. Vi har vært opptatt av å bruke forskjellige skisseringsmetoder og utforske ulike teknikker for å finne løsninger til vårt design: Digitale tegninger og -modeller, fysiske modeller og håndtegninger, vannforsøk, samt kombinasjoner av disse, har blitt brukt. For oss har prosessen i seg selv vært viktig, og ikke minst veldig gøy!

Christine og Hanne





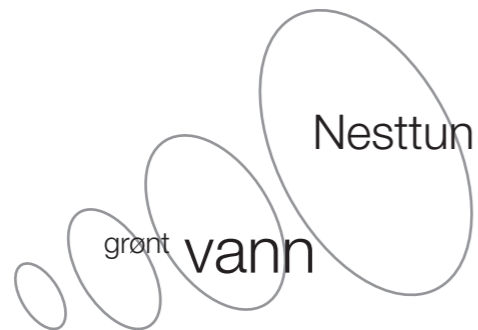

HVEM KOM FØRST?... ELVEN
ELLER PARKERINGSHUSET?



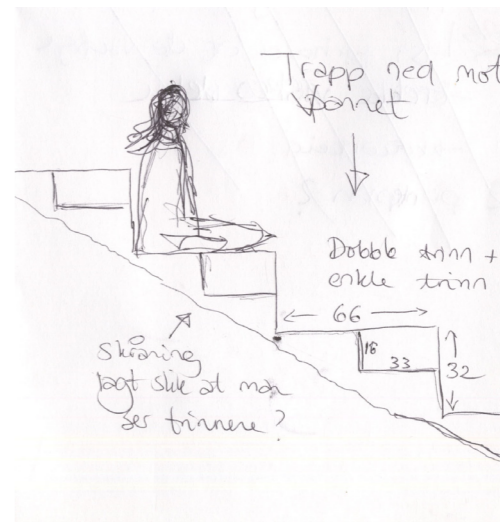
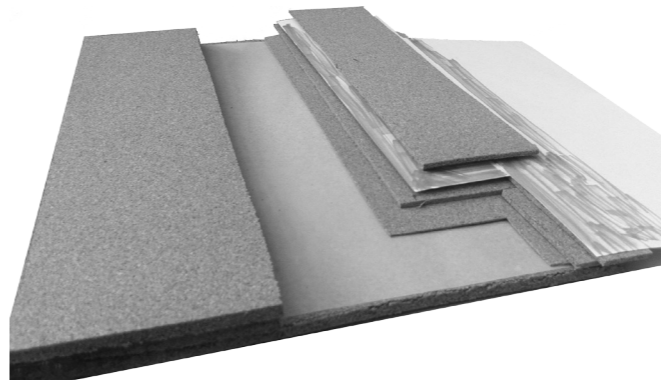
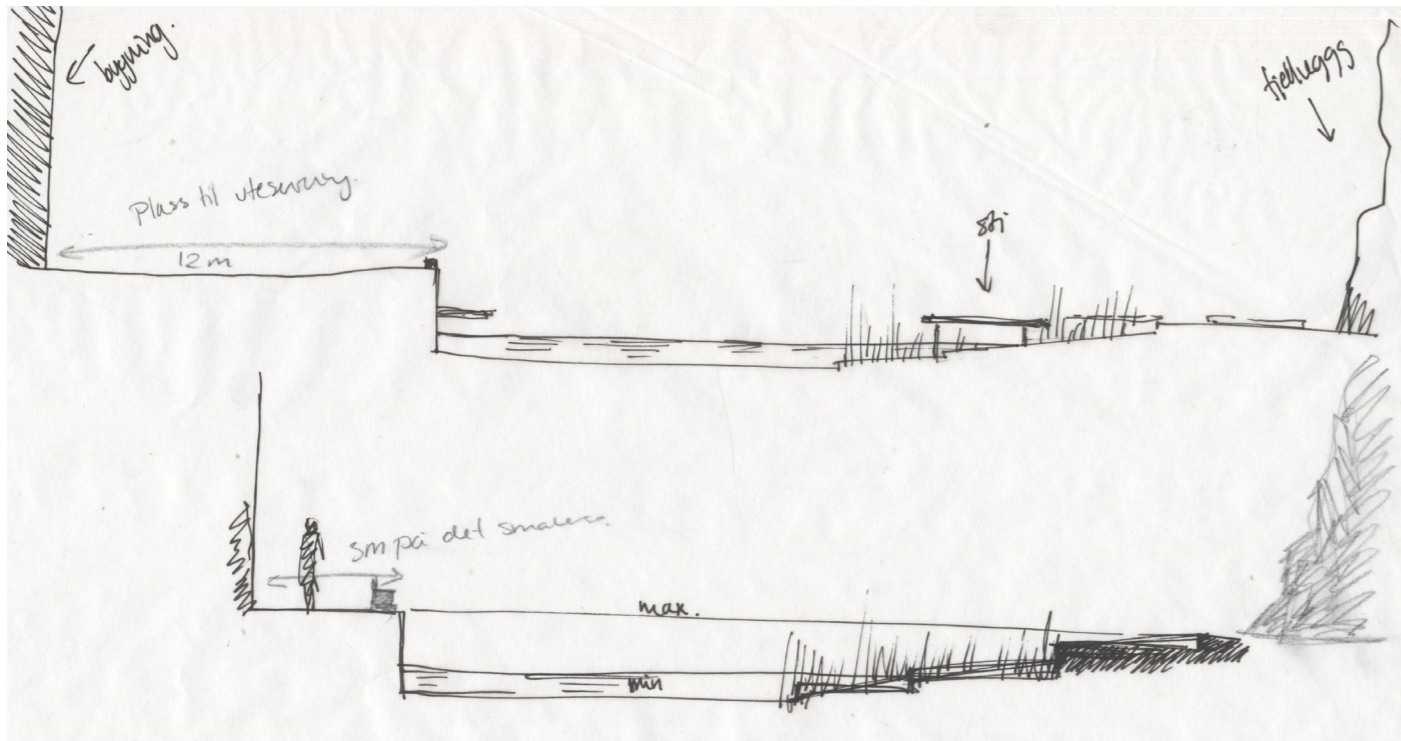

Ulike måter å komme nær vannet

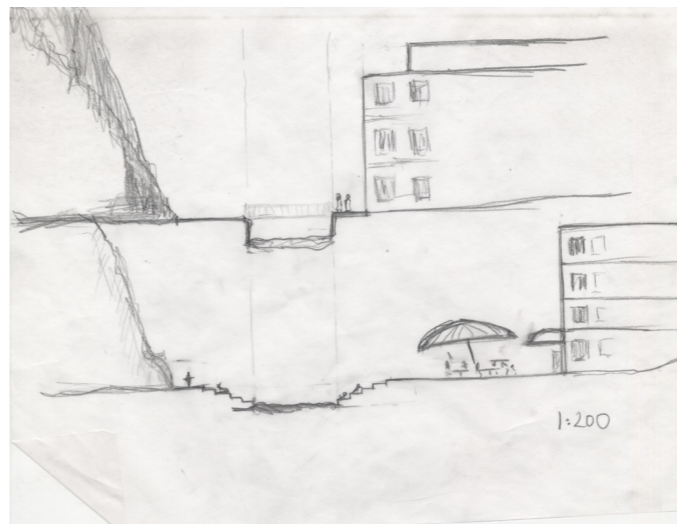

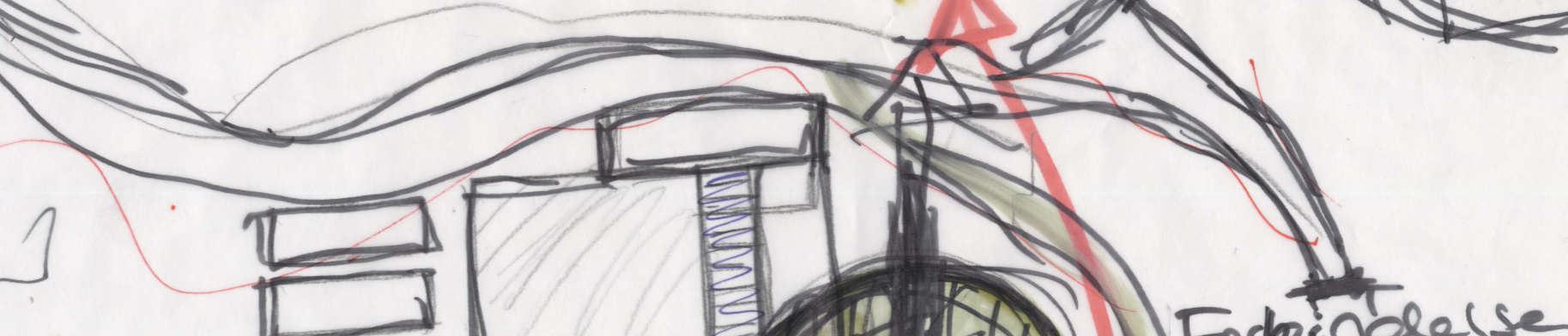
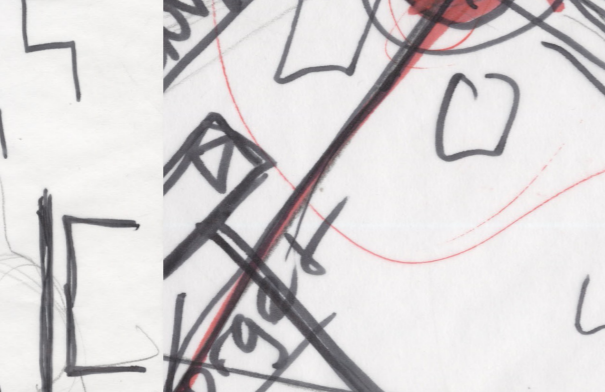

Forbindelser i sentrum

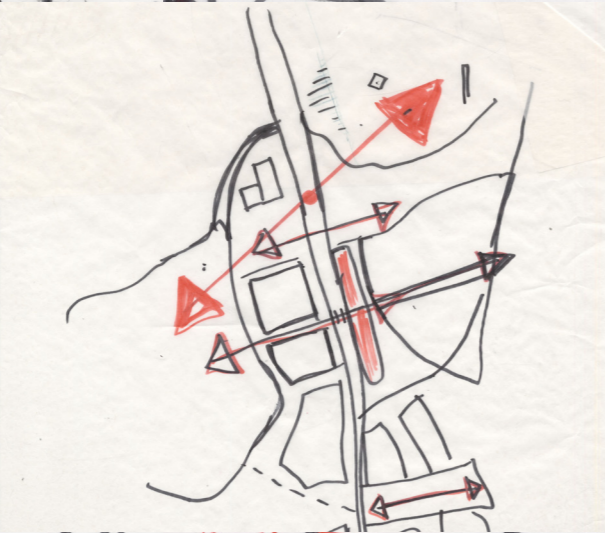
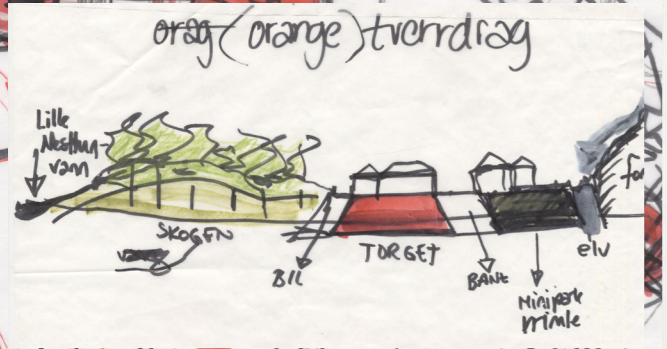

3

Plassering av bygg

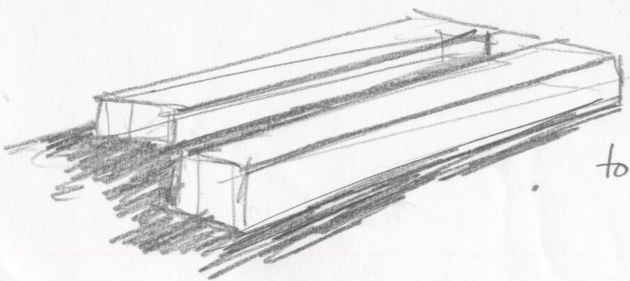
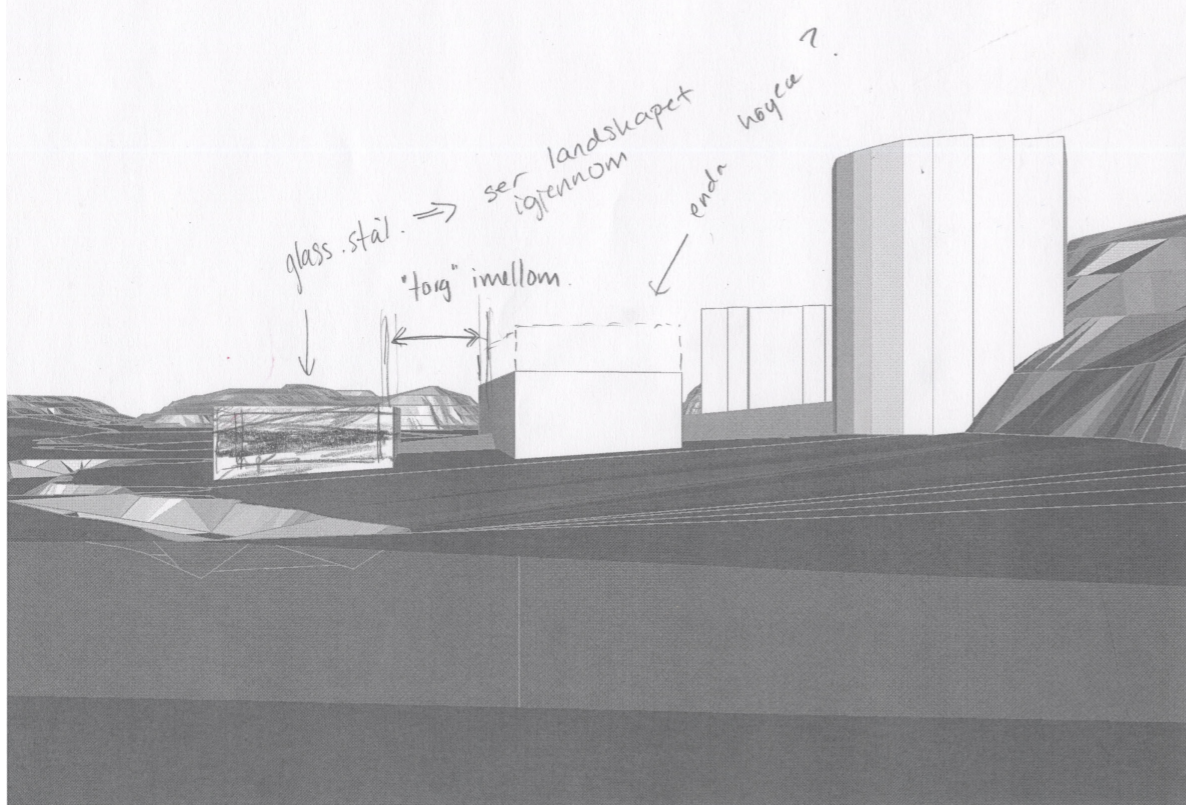

to line bygningsmasse

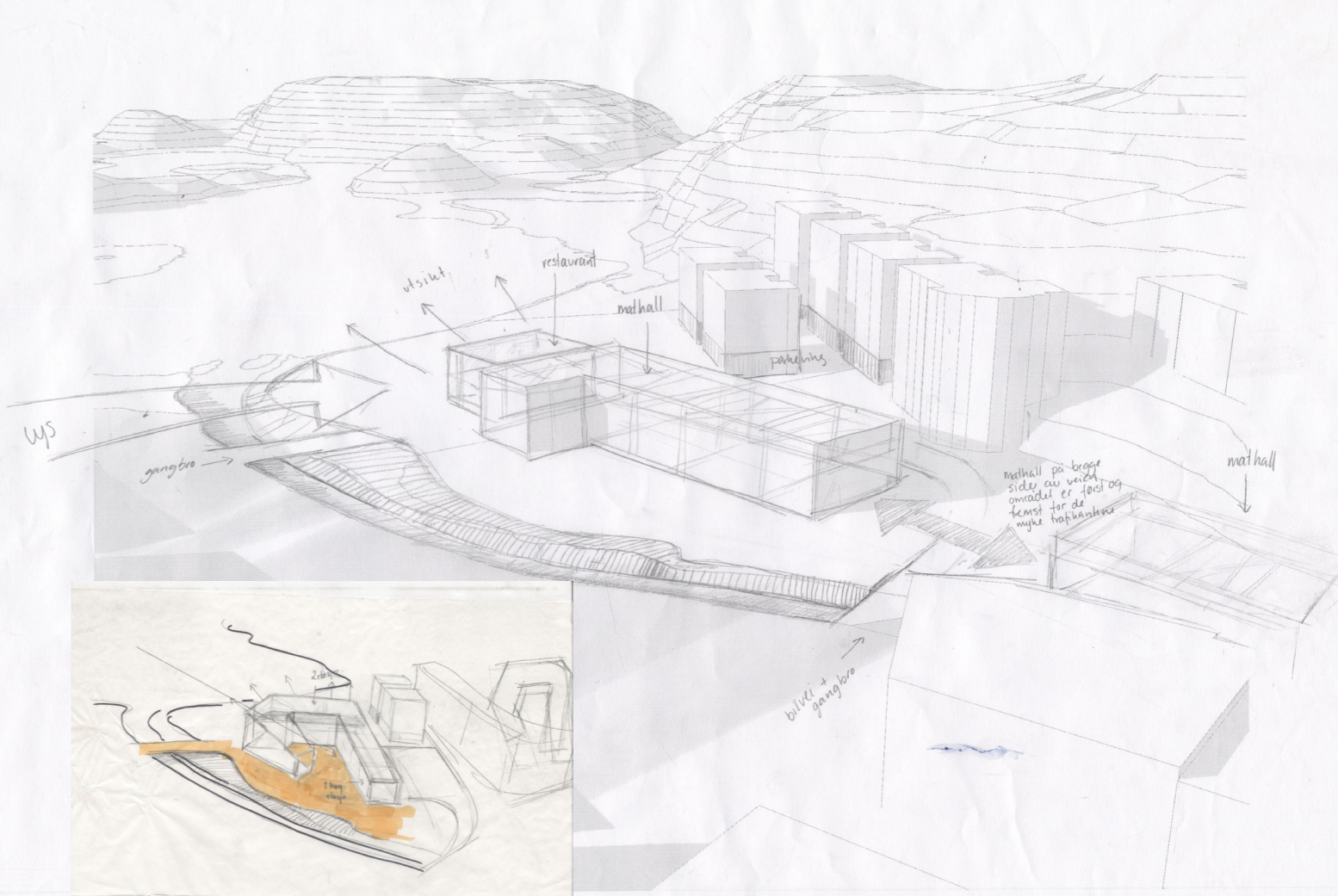

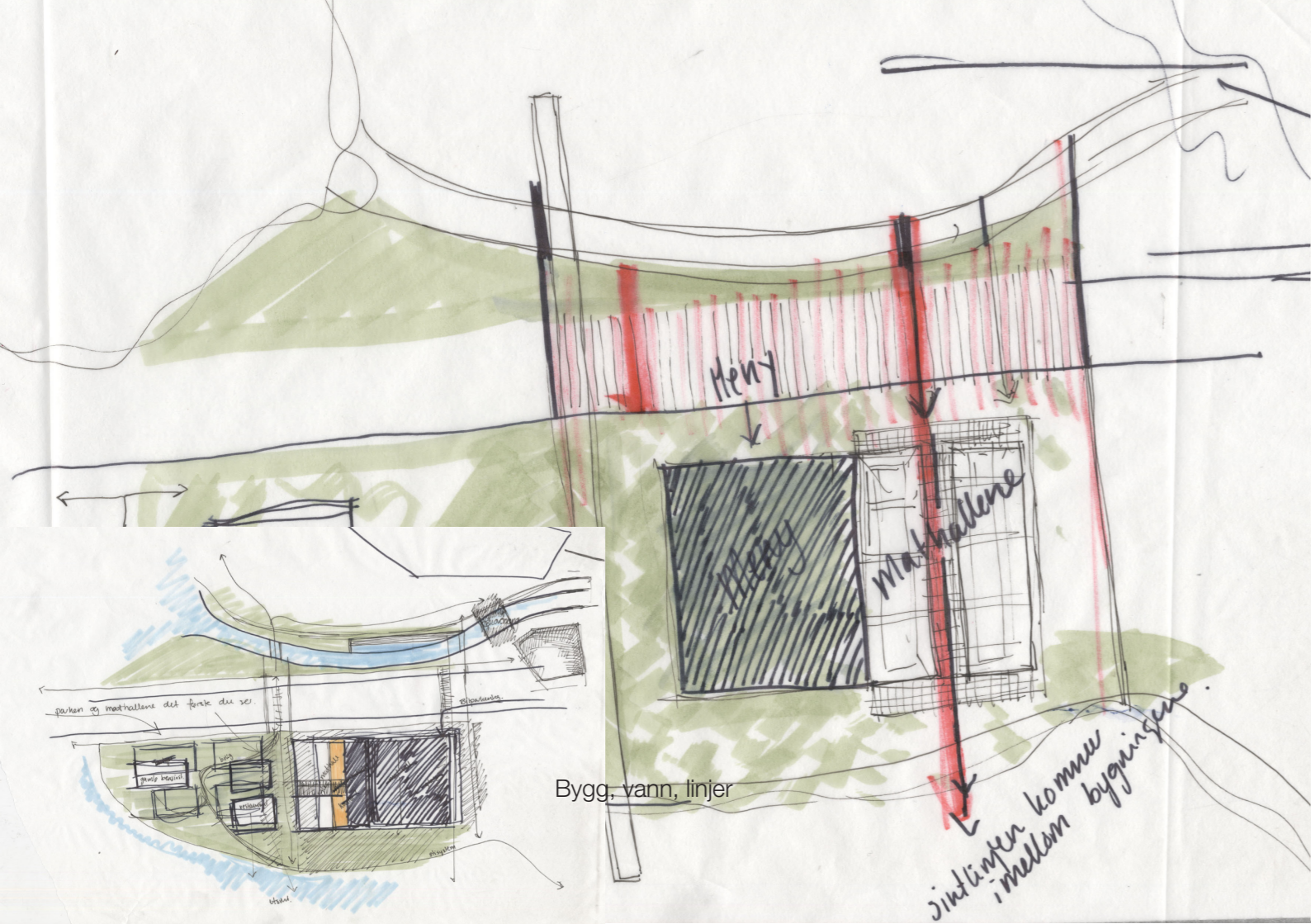

Bygg, vann, linjer



Størrelser og volum

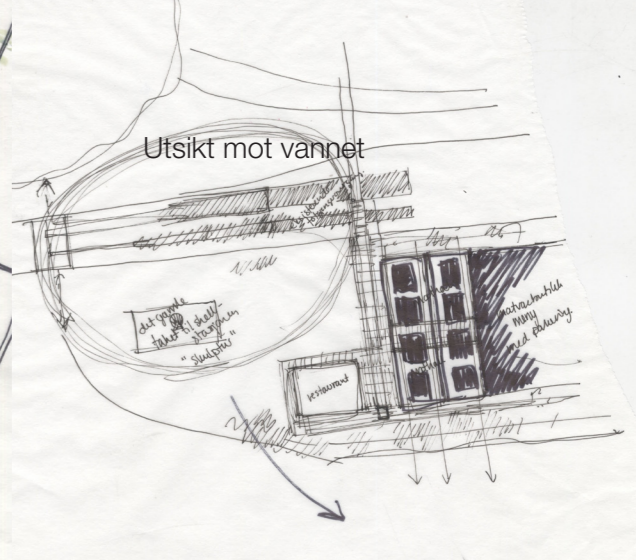

Utsikt mot vannet

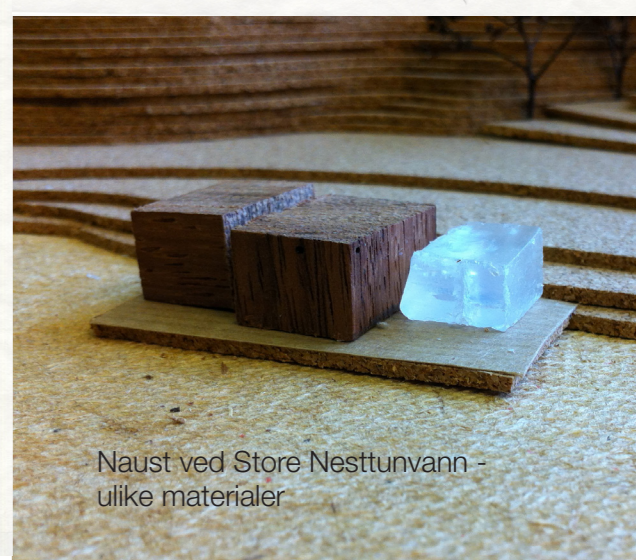

Naust ved Store Nesttunvann - ulike materialer

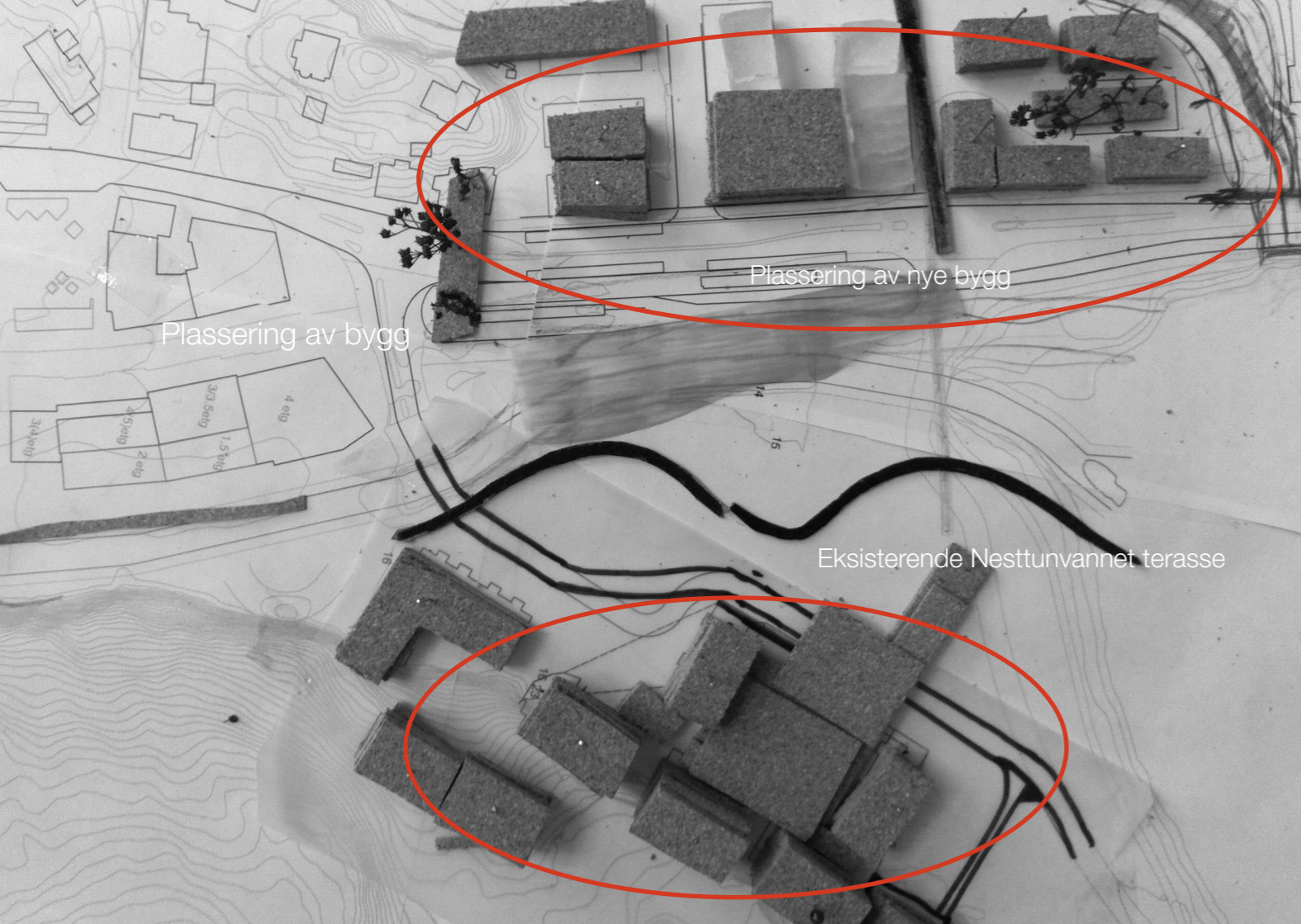

Hvor høyt skal man bygge?

Størrelser og volum

Høyhus og leilighetskomplekser ved
Lille Nesttunvann?

NEI!!

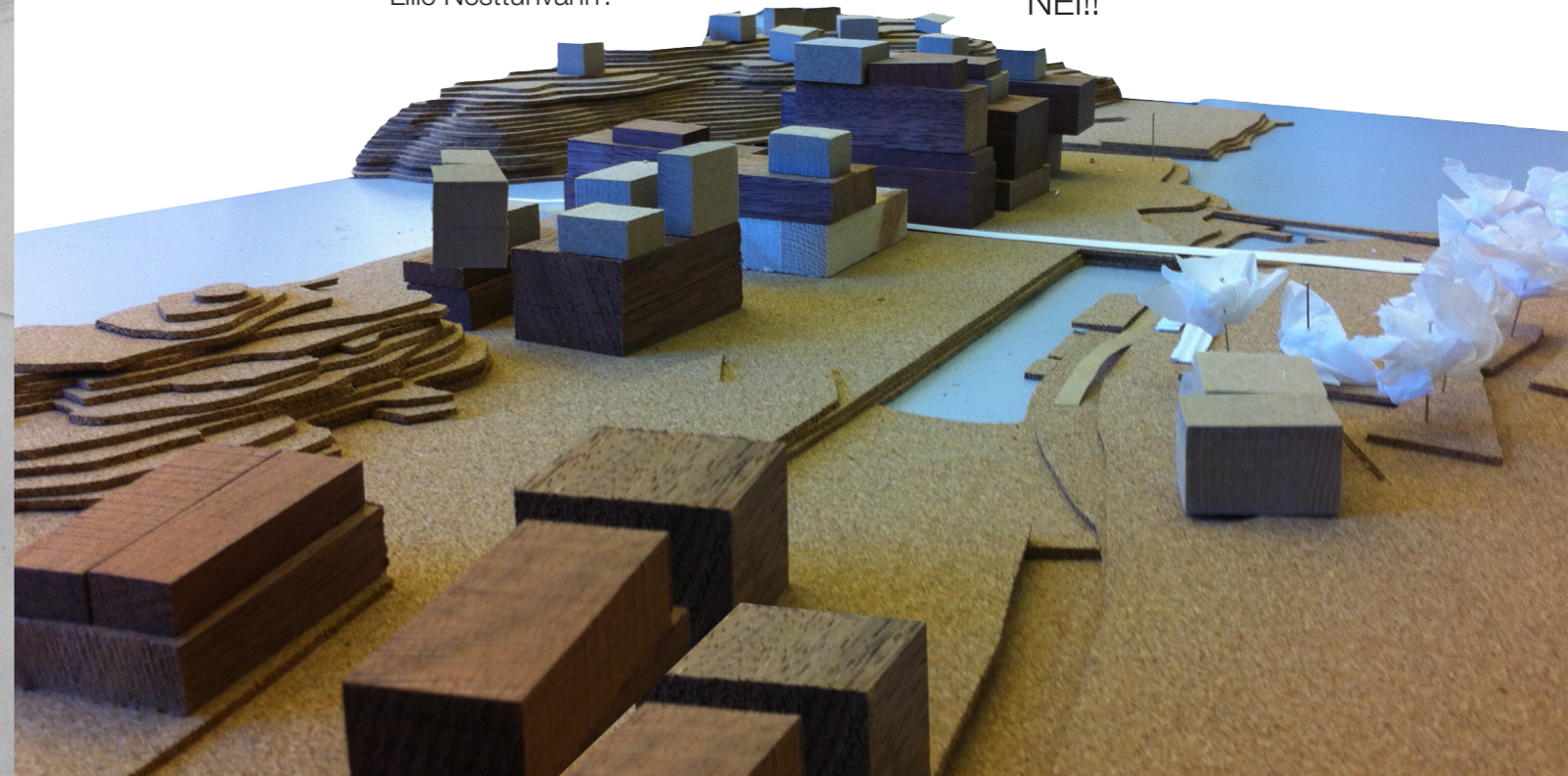

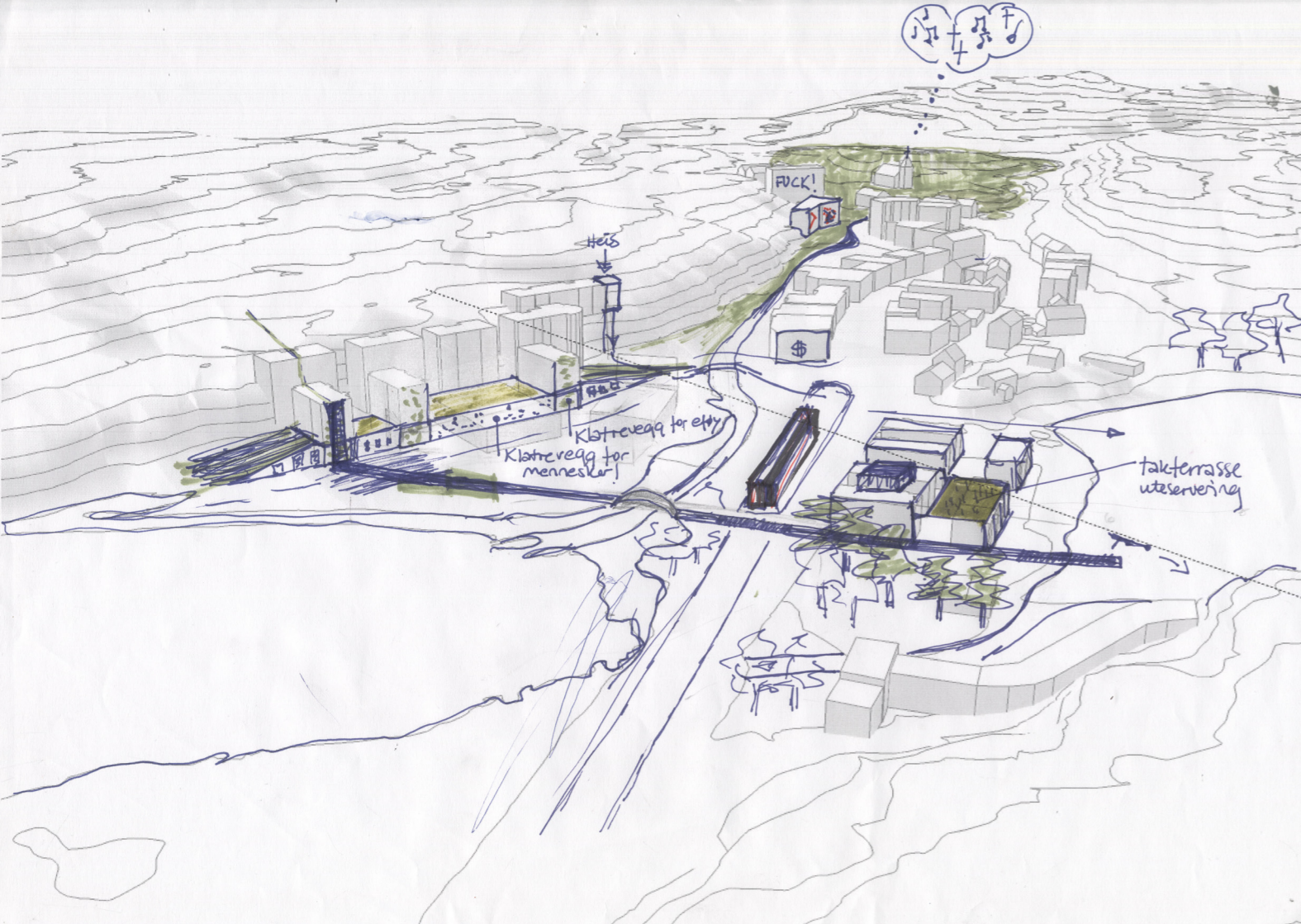

Kontraster

Vannforsøk og vannbesøk



Fart fart fart..... og rytme



Form og struktur

Utforming av helning/buffer mot nye/eks leiligheter

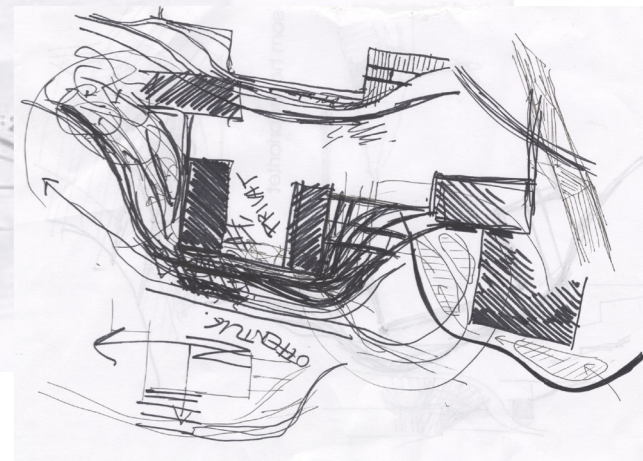
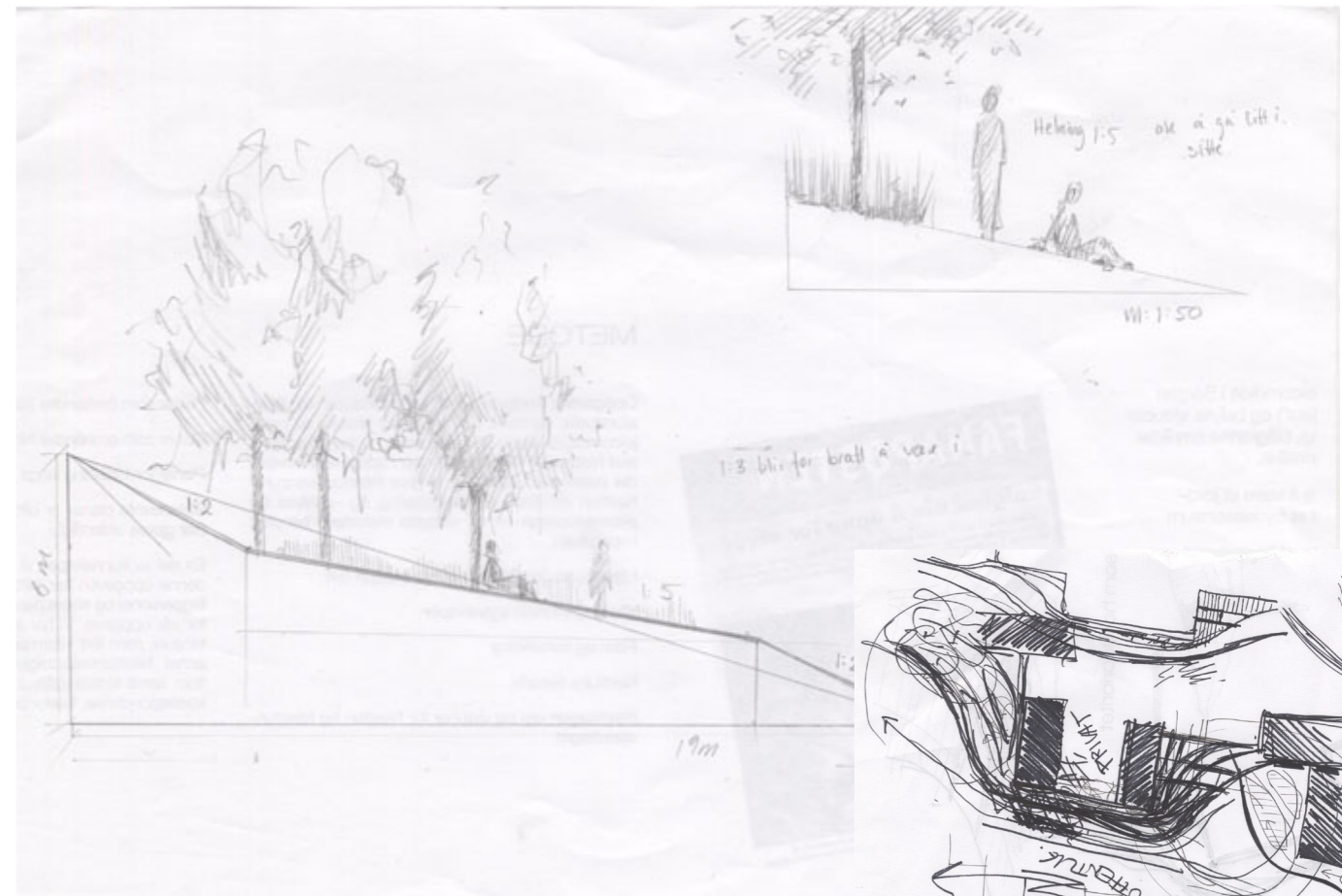
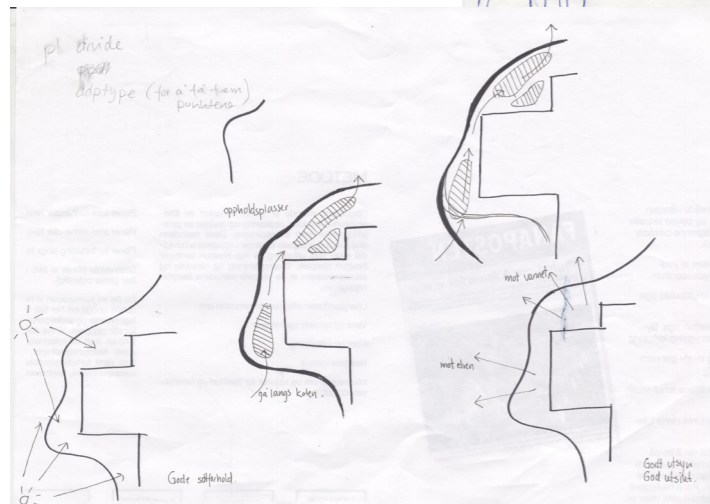

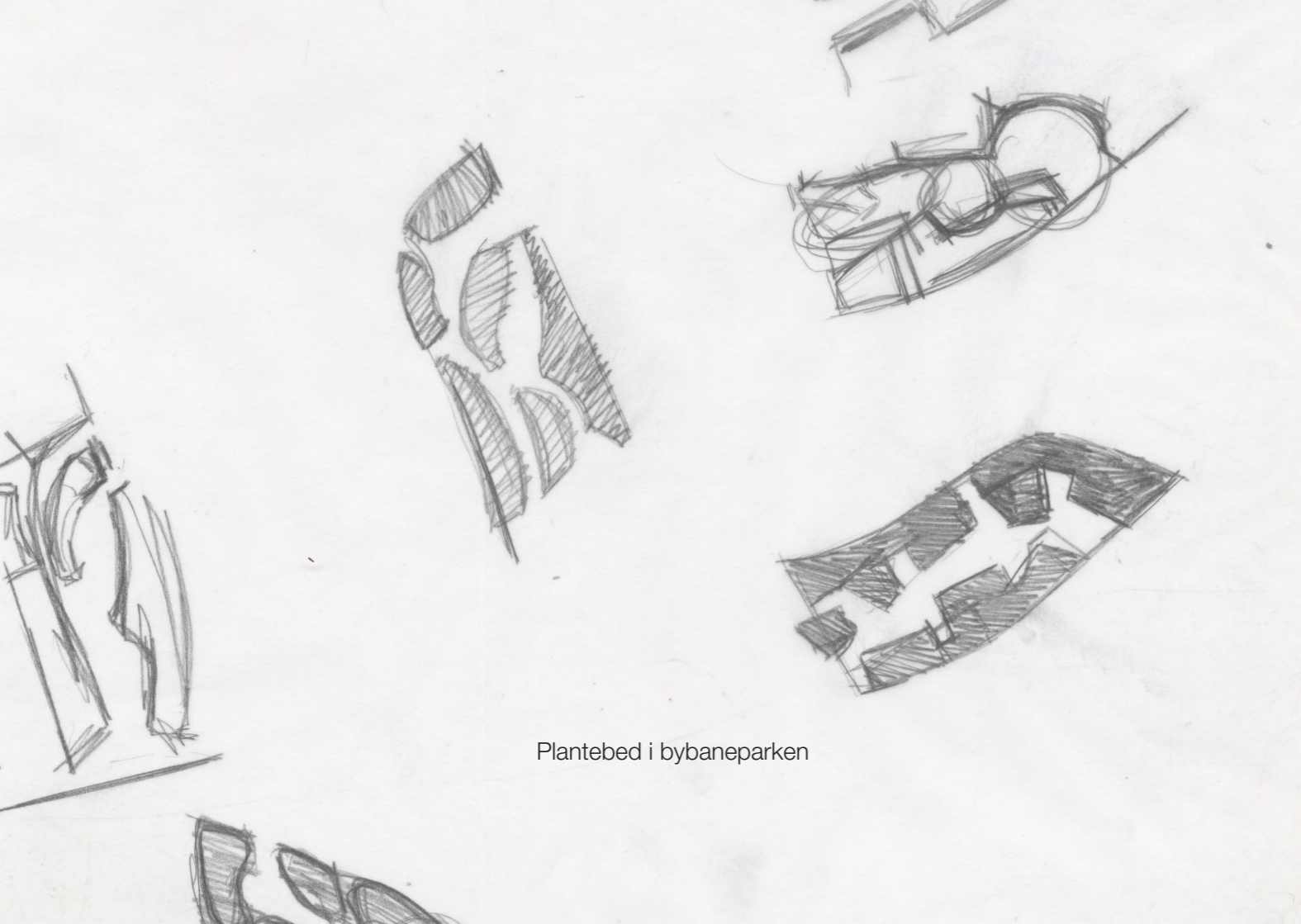

Plantebed i bybaneparken

Bryggekant ved mathall

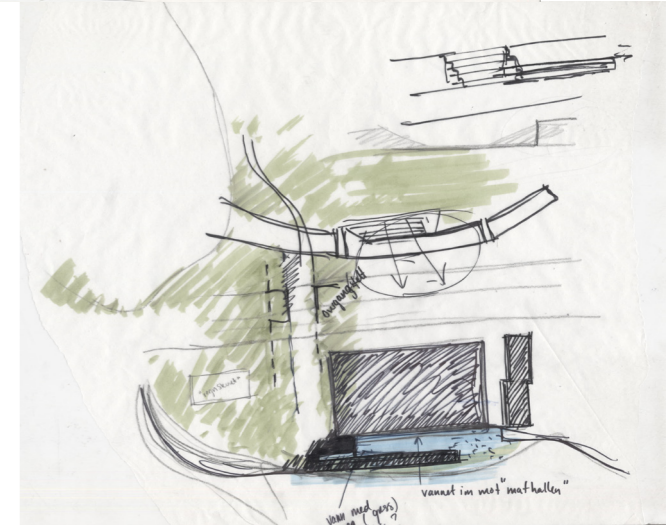
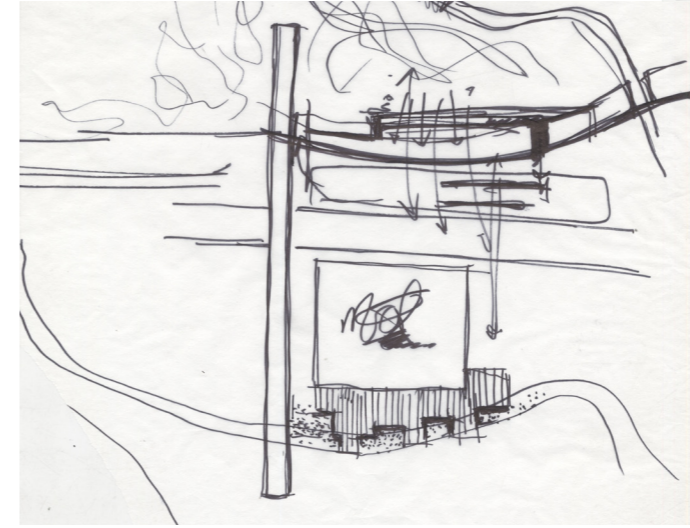
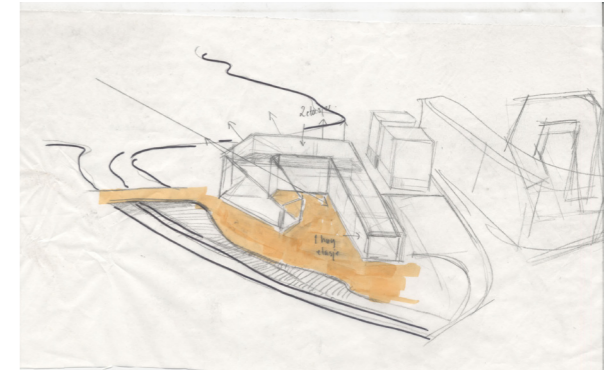

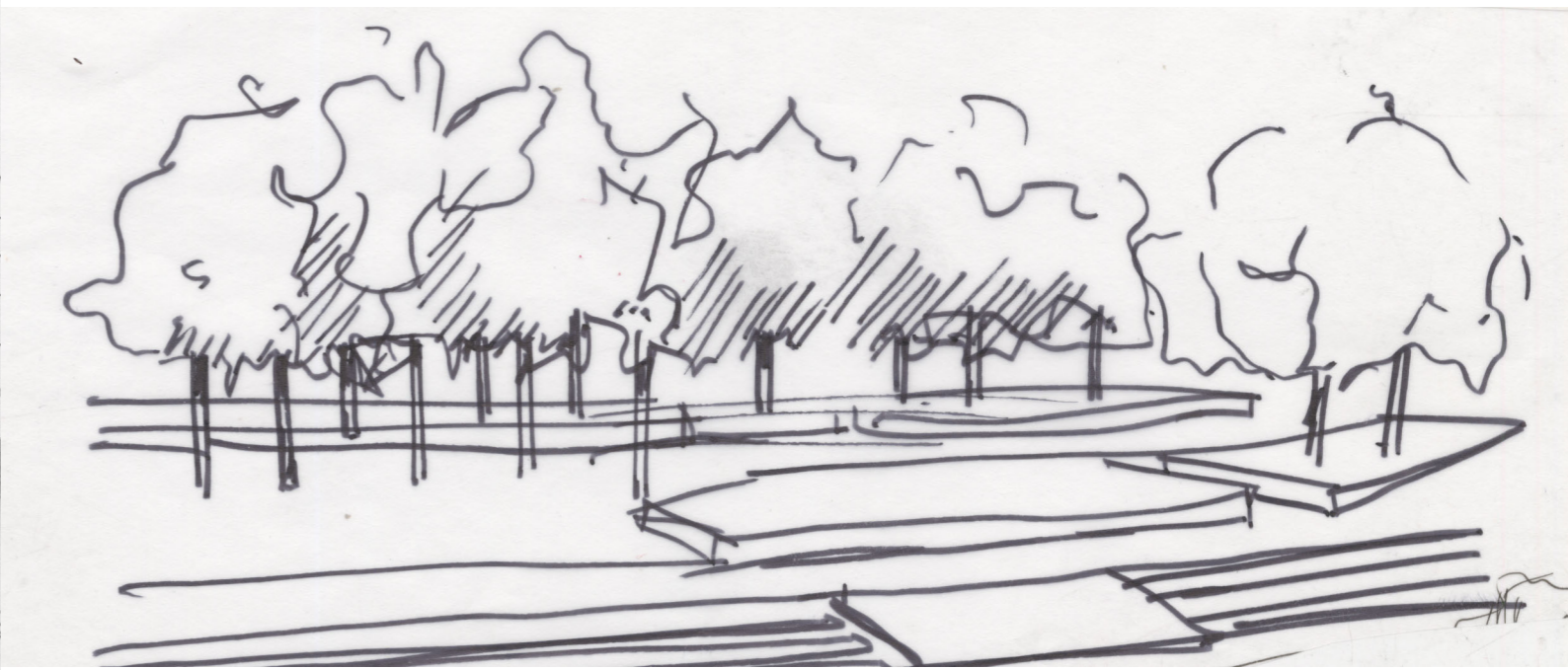
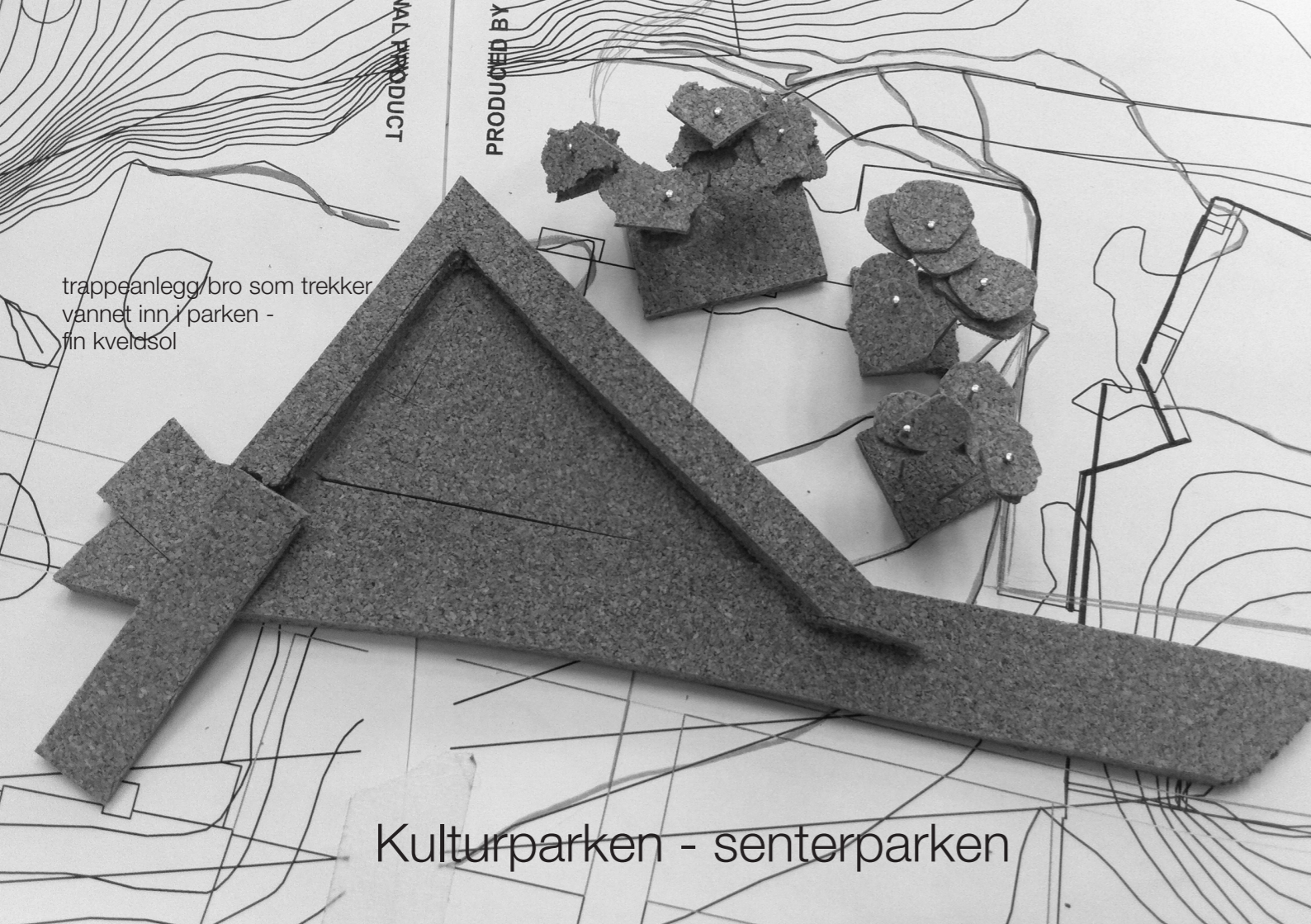

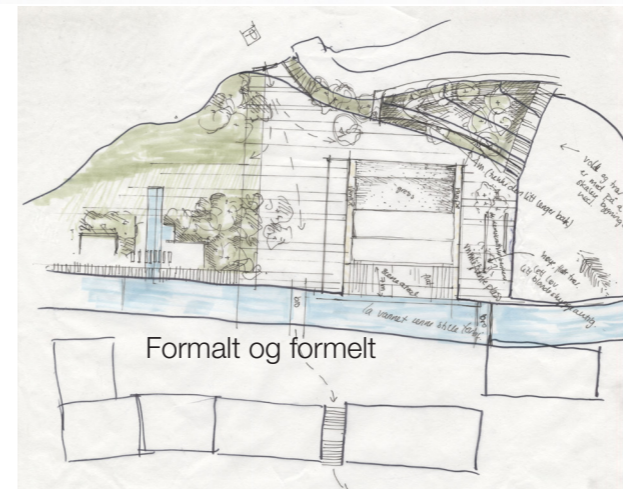
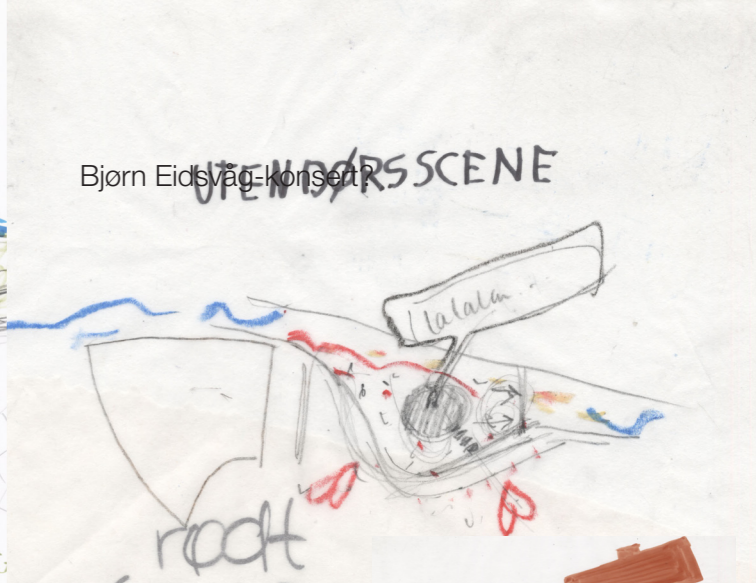
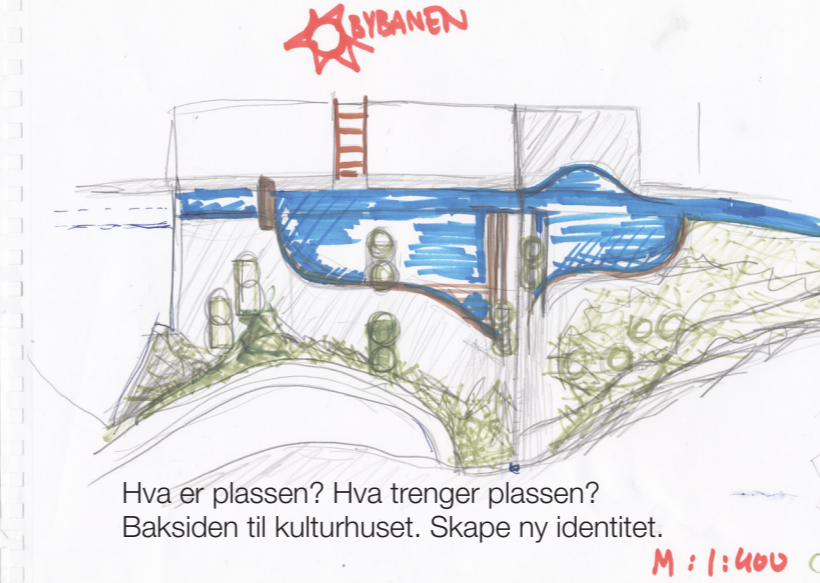
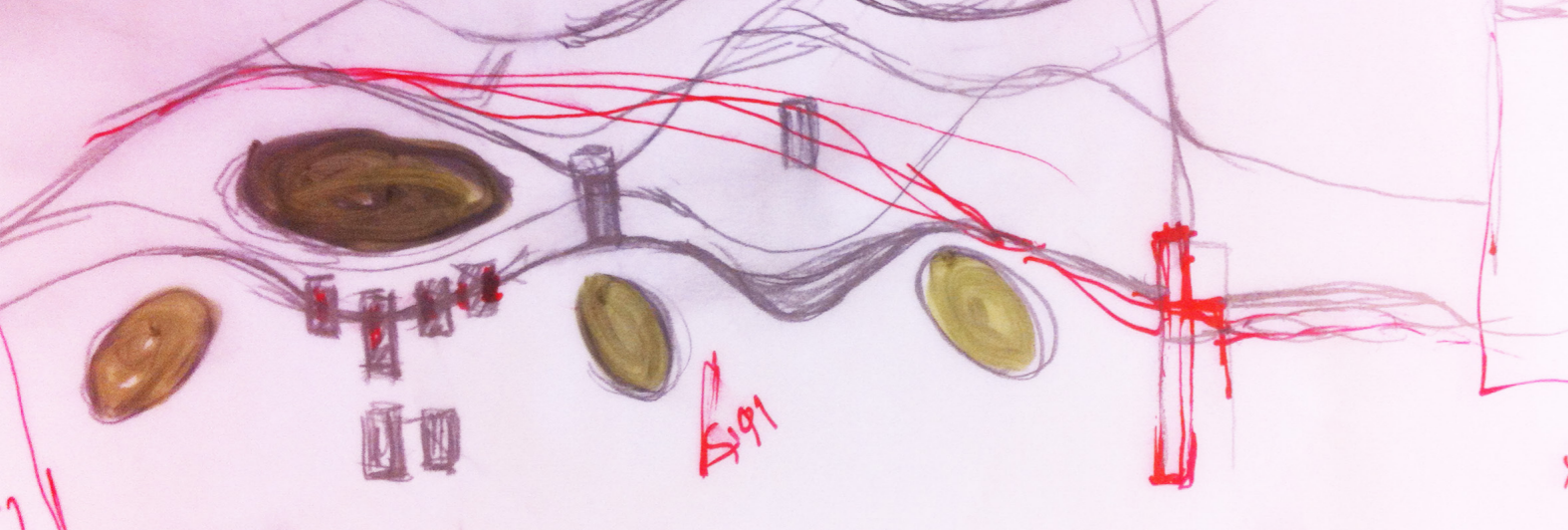



Public Utility & Group
[Illegible text]

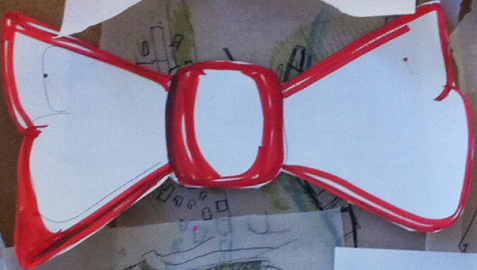

Toilet

